

INSTRUCTIONS FOR USE

For use with Nippon Rat and Mouse Wax Blocks and Nippon Rat and Mouse Fresh Bait or other appropriate bait products (not included). Place bait station where there are signs of rodent activity, like fresh droppings or near burrows, runways and feeding places. Place pre-baited stations throughout the infested area 10 metres apart, reducing to 5 metres in areas of high infestation. Protect bait stations from non-target animals and from water. Make daily inspections of the bait stations. Precautions should be taken to prevent domestic animals from having access to the bait.



RAT KILLER BAIT STATION



Effective rat control



RAT KILLER BAIT STATION

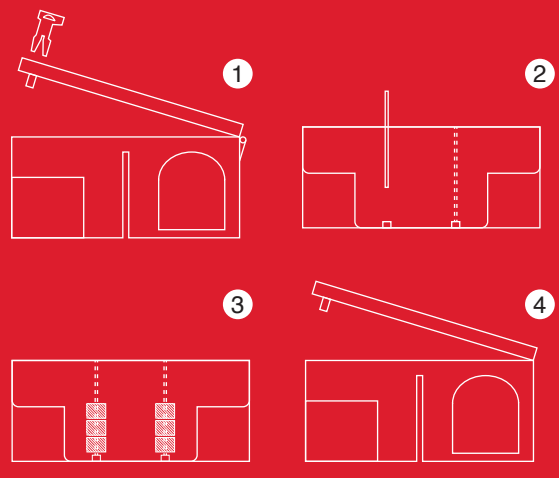

Insert the key provided into one set of fastening holes on the lid and turn to release the fastening.
Repeat the process with the second set of holes in the lid, allowing the lid to be lifted open.
Insert the bait securing rods provided into the slots in the floor of the baiting area. Place the bait onto the securing rods.
Close the lid, ensuring it is securely fastened.



Vitax Ltd,
Owen Street, Coalville, Leics, LE67 3DE.
Tel 01530 510060
www.vitax.co.uk

Nippon is a registered trademark of Vitax Ltd